

Lake Encroachment Permit Application

Under Chapter 11 of Title 29, § 401 *et seq.*



VERMONT DEPARTMENT OF ENVIRONMENTAL CONSERVATION
WATERSHED MANAGEMENT DIVISION
 LAKES & PONDS PROGRAM

Application Number:		
For Lake Encroachment Permitting Use Only		
Submission of this application constitutes notice that the person in Section B intends to encroach beyond the mean water level of a lake or pond, and certifies that the project will comply with Chapter 11 of Title 29, § 401 <i>et seq.</i> All information required on this form must be provided, and the requisite fees (Section J) must be submitted made payable to the State of Vermont.		
A. Project Information		
1. Physical Address (911 Address): 1378 Shadow Lake Road		
2a. Town - County: Glover - Orleans		2b. Zip: 05839
3a. SPAN (###-###-####): 243-077-10556	(School Parcel Account Number can be obtained from your property tax bill or from your Town Clerk)	
3b. Coordinates (decimal degrees, can be found on Google Maps):	Latitude: 44.66372	Longitude: 72.22058
4. Name of Lake/Pond: Shadow Lake - Glover		
5a. Have you ever applied for a permit with the Agency of Natural Resources associated with this parcel? <input type="radio"/> Yes <input checked="" type="radio"/> No		
5b. If yes, please describe (e.g., Wetlands, Act 250, Wastewater, etc):		
B. Applicant Contact Information		
1. Name: Vermont Fish & Wildlife Department		
2a. Mailing Address: 1 National Life Drive, Davis 2		
2b. Town: Montpelier	2c. State: VT	2d. Zip: 05620-3702
3. Phone: 802-917-1347	4. Email: Mike.Wichrowski@Vermont.gov	
5a. Have you completed the voluntary Natural Shoreland Erosion Control Certification course? <input checked="" type="radio"/> Yes <input type="radio"/> No		
5b. If yes, please include the location and year you attended the course: 11/2016 Assoc. of General Contractors of VT If no, a list of certified contractors is available online.		
C. Application Preparer Information (If the individual preparing the application is not the landowner)		
1. Name: John Roman, Environmental Technician V, Agency Facilities Section		
2a. Mailing Address: 1 National Life Drive, Main Building, 1st Floor		
2b. Town: Montpelier	2c. State: Montpelier	2d. Zip: 05602-3510
3. Phone:	4. Email:	
5a. Have you completed a voluntary Natural Shoreland Erosion Control Certification course? <input checked="" type="radio"/> Yes <input type="radio"/> No		
5b. If yes, please include the location and year you attended the course: Grand Isle, Lake Champlain Basin Program 1/20/2016 If no, a list of certified contractors is available online.		
D. Project Description		
1. Describe the proposed project including the materials and equipment that may be used during construction. Please include: (a) volume of fill added and/or removed; (b) dimensions of proposed project; (c) distance beyond mean water level the project will extend; and (d) linear feet of shoreline impacted. If this project is to remove and replace an existing encroachment, please include the dimensions of the existing structure. Installation of a Geo textile filter curtain to perform excavation with use of a medium-duty tracked excavator, to remove approximately 25 CY of lake bottom comprising an area of approximately 950 Sq Ft. The project footprint will extend approximately 30 feet beyond mean water level (MWL), representing approximately 890 Sq. Ft of work area below shoreland lake elevation (SLE) along approximately 70 lin. ft. of shoreline.		

2. Describe the purpose of the proposed project:

This project is being completed to remove sediment build-up upon the existing concrete ramp surface and to improve and slightly deepen and smooth lake-bottom surfaces along the approach ramp sides to assure sufficient free board for boaters throughout the year.

3. Describe what less intrusive feasible alternatives have been considered:

The proposed work currently represents the least intrusive approach to correcting sediment build-up. The existing ramp profile is suitably situated and sloped to provide acceptable launch and retrieval of trailered and non-motorized vessels. The minor dredging is anticipated to be a sufficiently long-term correction, however post dredging monitoring of potential sediment re-accumulation will be conducted to evaluate need for possible breakwater extension. More intrusive measures of ramp extension and/or steepening it's profile, or extending the footprint of the breakwater is not considered necessary at this time.

4. Describe the public benefits of the proposed project (e.g., erosion control, improvements to boating/swimming/fishing, public access, etc.):

The project is located at an existing public access area. The newly dredged ramp width is no greater than what is already established and therefore will not impact surrounding vegetation of the immediate shoreline, while the ramp is below water and not visible from a distance. The project is considered consistent with the existing natural surroundings.

E. Encroachment Effects

1. What measures are proposed to minimize the project's effects on water quality (e.g., use of a turbidity curtain during construction, heavy equipment will work from shore, etc.)?

A silt curtain will be installed in the lake around the work area, extending from the surface to the bottom and will be secured to the lake bottom, and reinforced as necessary against impact from wind or wave current. The curtain will be maintained until the project is complete and turbidity within the curtain has decreased to the level of turbidity outside the curtain. The project will have limited negative impacts during construction due to disturbance of the lake bottom in the immediate project area only. The project's long-term impact on water quality will be positive by reducing turbidity caused by launching / retrieval activities as excessive sediment deposits will be removed.

2. How will the project minimize effects to fish and wildlife habitat (e.g., project is not to commence until July 1 of the calendar year to avoid spring fish spawning)?

The project is located at an existing public boat launch ramp and immediately adjacent breakwater, and will address sedimentation issues. The lake bottom at the access is already disturbed and does not constitute quality aquatic habitat.

3. Does the project propose removal of aquatic or shoreline vegetation? If removing shoreline vegetation (e.g., trees, shrubs, groundcover, duff layer), a Shoreland Protection Permit may be needed.

The project is located within an existing launching area with an altered bottom containing little or no aquatic vegetation, and will not have a measurable new impact on aquatic vegetation.

4. Describe the surrounding shoreline. What measures are proposed to ensure the project is consistent with the surroundings?

The project is located at an existing public access area. The ramp footprint will remain unchanged and minor dredging will not impact surrounding vegetation of the immediate shoreline. The project is to maintain the integrity of the existing site's vegetation and is considered to be consistent with the existing natural surroundings.

5. Will the project impact navigation, recreation, or other public uses? If so, how will these effects be minimized?

The ramp will be closed to use during the project, limiting public access for a period during construction. However the completed project will have a long-term positive effect on boating and boating-related recreational activities such as fishing, as the public ramp will be easier and safer to use. A sign informing the public of the impending access closure will be required to be posted thirty (30) days prior to the closure of the ramp. Public use will only be impacted during the actual construction phase, anticipated to be completed within a three-week period.

F. Applicant Certification

As APPLICANT, I hereby certify that the statements presented on this application are true and accurate and recognize that by signing this application, I agree to complete all aspects of the project as authorized. I understand that failure to comply with the foregoing may result in violation of the Chapter 11 of Title 29, § 401 *et seq.*, and the Vermont Agency of Natural Resources may bring an enforcement action for violations of the Act pursuant to 10 V.S.A. chapter 201.

Applicant/Landowner Signature:  Date: 1/16/19

G. Applicant Preparer Certification (if applicable)

As APPLICATION PREPARER, I hereby certify under penalty of law that this document and all attachments were prepared under my direction or supervision in accordance with a system designed to assure that qualified personnel properly gathered and evaluated the information submitted. Based on my inquiry of the person or persons who manage the system, or those persons directly responsible for gathering the information, the information submitted is, to the best of my knowledge and belief, true, accurate, and complete. I am aware that there are significant penalties for submitting false information, including the possibility of fine and imprisonment for knowing violations.

Application Preparer Signature: John Roman Digitally signed by John Roman
Date: 2019.01.08 16:01:18
-05'00' Date: 01/08/2019

H. Adjoining Property Owner Notification (For additional information, please see the [Adjoining Property Owner Notification Guidance](#))

I certify, by initialing to the left, that I have notified adjoining property owners of the proposed project using the [letter](#) template sent by U.S. Mail.

I. Additional Required Documentation (Please check to ensure you have completed the following)

- All sections of the application are complete or otherwise indicate "not applicable";
- Application includes site plans with dimensions
- Project description includes distance beyond mean water level the project will extend;
- Application includes photos of project area.

J. Permit Application Fees

Select the most applicable permit description and requisite fee. If the proposed project involves more than one of the project types, multiple fees may apply. For example, a project involving structural shoreline stabilization and marina improvement will require both fees (2) and (3).

1. Non-structural erosion control project (e.g., dry-laid rip rap or natural stone):

Administrative Processing Fee: \$155.00	
Total:	

2. Structural erosion control project (e.g., vertical wall replacement)

Administrative Processing Fee: \$250.00	
Total:	

3. Other Projects (e.g., marina improvements, boathouse repair, dredging):

Administrative Processing Fee: \$300.00		\$ 300.00
Application Review Fee: 1% of Total Project Cost	Enter the Total Project Cost: \$ 8,500.00	\$ 85.00
Total Fee:		\$ 385.00

Submit this form and appropriate fee, payable to:
 State of Vermont - Vermont Department of Environmental Conservation
 Watershed Management Division - Shoreland Permitting
 1 National Life Drive, Main 2
 Montpelier, VT 05620-3522

Refund Policy:

- If an application is modified, withdrawn or denied after technical review has commenced; all fees are retained.
- If an application is withdrawn prior to administrative review; all fees will be refunded.
- If an application is withdrawn after administrative review but prior to commencement of technical review, deemed administratively incomplete and returned to applicant, or determined that a permit is not required; administrative fees are retained and permit application review fees will be refunded.



Lake Encroachment Application Addendum

For a Lake Encroachment Permit

Chapter 11 of Title 29, § 401 *et seq.*

This Abutting Land Owner Addendum is intended to accompany a completed *Lake Encroachment Permit Application* in instances of a proposed lake encroachment abutting land owners other than the applicant.

I. Abutting Land Owner Information

1. Name: Vermont Fish & Wildlife Department

Address: 1 National Life Drive, Davis 2, Montpelier VT 05602

2. Name: Pamela Peters

Address: 1383 Shadow Lake Road, Glover, VT 05839

3. Name: Joan Spencer Weston

Address: PO Box 76, East St. Johnsbury, VT 05838

4. Name: Roland & Sharon Bickford

Address: 196 Roaring Brook Road, Apt 5C, Barton, VT 05822

5. Name: Nellie Peck Estate

Address: 1385 Shadow Lake Road, Glover, VT 05839

6. Name: Town of Glover

Address: 51 Bean Hill, Glover, VT 05839

7. Name:

Address:

8. Name:

Address:

9. Name:

Address:

10. Name:

Address:

Submit this form as an addendum to a complete Lake Encroachment Application to:

**State of Vermont
 Vermont Department of Environmental Conservation
 Watershed Management Division
 Lake Encroachment Permitting 1
 National Life Drive, Main 2
 Montpelier, VT 05620-3522**

Direct all correspondence or questions to Lake Encroachment Permitting at:
ANR.WSMDSshoreland@vermont.gov

For additional information visit: <http://dec.vermont.gov/watershed>



PARCEL INFORMATION:

- 1) Vermont Fish & Wildlife Department, 1 National Life Drive, Davis 2, Montpelier, VT 05602
- 2) Parcel #243-077-10043, Pamela Peters, 1383 Shadow Lake Road, Glover, VT 05839
- 3) Parcel #243-077-10234, Joan Spencer Weston, PO Box 76, East St. Johnsbury, VT 05838
- 4) Parcel #243-077-10042, Ron & Sharon Bickford, 196 Roaring Brook Rd, Barton, VT 05822
- 5) Parcel #243-077-10560, Nellie Peck Estate, 1385 Shadow Lake Rd, Glover, VT 05839
- 6) Town of Glover, 51 Bean Hill, Glover, VT 05839

DESIGNED: JJB
 DRAWN: JCR
 CHECKED: JJB
 REVISION 1: 11/30/17
 REVISION 2:
 REVISION 3:

STATE OF VERMONT
 AGENCY OF NATURAL RESOURCES
 DEPARTMENT OF ENVIRONMENTAL CONSERVATION
 FACILITIES ENGINEERING DIVISION
 MONTPELIER, VERMONT 05620-3510

DEPARTMENT
 DEPARTMENT OF FISH & WILDLIFE

PROJECT
 SHADOW LAKE ACCESS PARCEL MAP

TOWN: GLOVER
 STATE: VERMONT
 DATE: 11/30/17
 DATUM: N/A
 SHEET: 1 OF 1
 SCALE: N.T.S.

Photo Log in Support of Shoreline Encroachment Permit:

**Vermont Fish & Wildlife
Shadow Lake Access Area
Boat Ramp Improvements
1378 Shadow Lake Road
Glover, VT 05839**



Photo 1: Shadow Lake Access Area Parking Entrance and Milfoil Check Station.

Photo 2: Approach to boat launch.



Photo Log in Support of Shoreline Encroachment Permit:

Vermont Fish & Wildlife
Shadow Lake Access Area
Boat Ramp Improvements
1378 Shadow Lake Road
Glover, VT 05839



Photo 3: Ramp launch area facing north at stone breakwater.

Photo 4: Ramp launch area facing east at along south shore edge.



PROJECT DESCRIPTION: THE PROJECT WILL CONSIST OF PLACEMENT OF A GEO-TEXTILE FILTER CURTAIN TO ENCLOSE THE WORK AREA IN ORDER TO PREVENT EROSION OF THE BANKS AND TO STABILIZE THE RAMP SURFACE AND FOR STABILIZATION OF THE BOAT RAMP APPROACH. THE PROJECT SHALL INCLUDE ALL NECESSARY ACCESSIBLE UTILITIES AND STRUCTURES AS SHOWN ON THE PLANS, AS SPECIFIED AND DIRECTED.

PROJECT LOCATION: (LAT 44.86372, LON 72.22089) THE PROJECT IS LOCATED AT THE VERMONT FISH & WILDLIFE AGENCY SHADOW LAKE BOAT RAMP, 1570 SHADOW LAKE ROAD, CLOVER, VERMONT. TAKE EXIT 25 OFF US INTERSTATE 91, TURN WEST, CONTINUE PAST GLOVER CENTER, TURN RIGHT ON SHADOW LAKE ROAD TO ACCESS AREA.

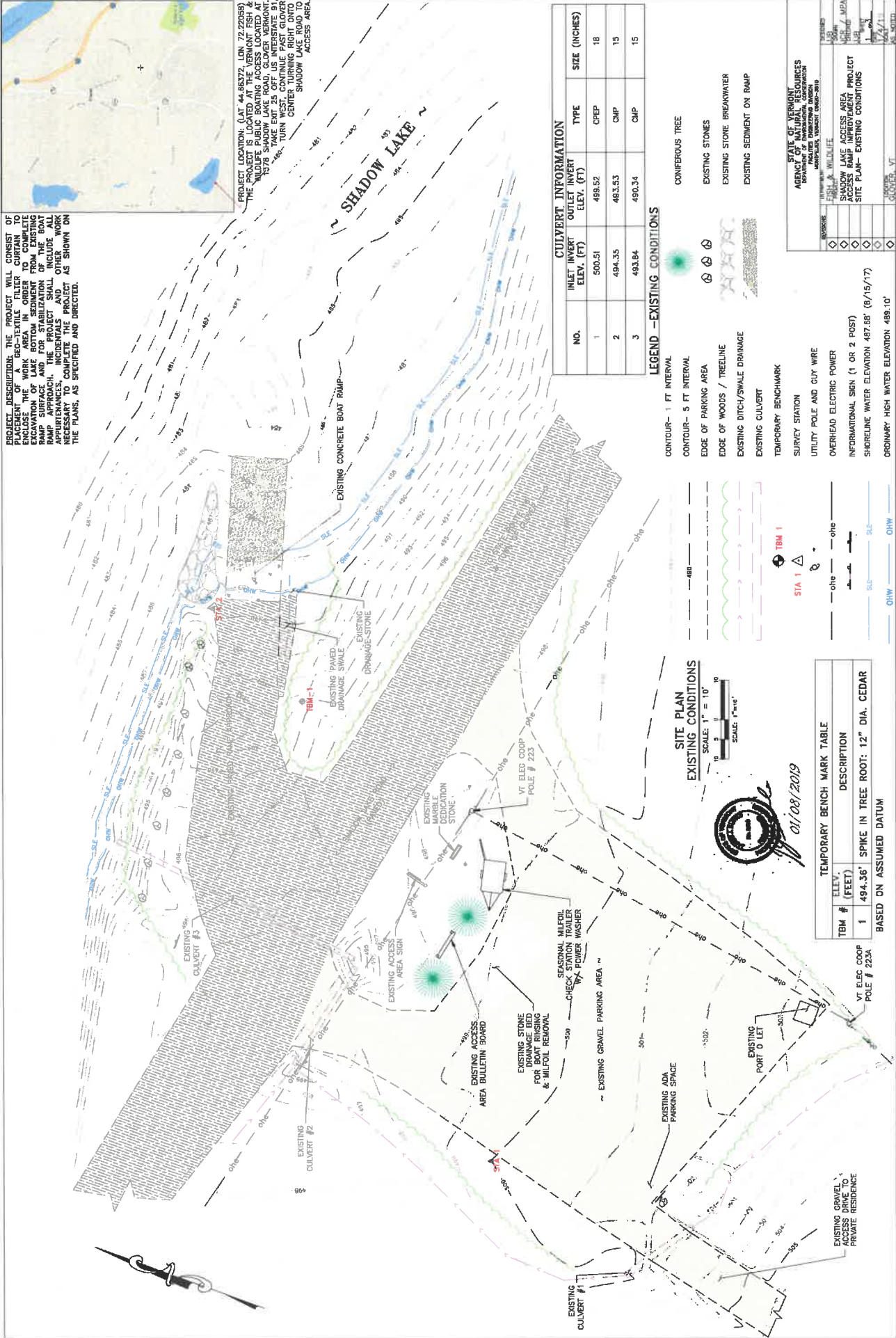
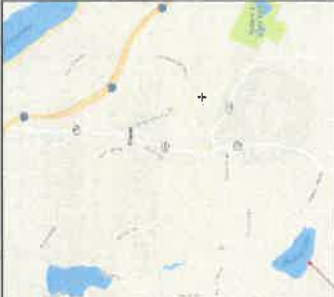

CULVERT INFORMATION				
NO.	INLET INVERT ELEV. (FT)	OUTLET INVERT ELEV. (FT)	TYPE	SIZE (INCHES)
1	500.51	489.52	CPEP	18
2	494.35	483.53	CMP	15
3	483.84	490.34	CMP	15

LEGEND - EXISTING CONDITIONS

- CONTOUR - 1 FT INTERVAL
- CONTOUR - 5 FT INTERVAL
- EDGE OF PARKING AREA
- EDGE OF WOODS / TREELINE
- EXISTING DITCH/SWALE DRAINAGE
- EXISTING CULVERT
- TEMPORARY BENCHMARK
- SURVEY STATION
- UTILITY POLE AND GUY WIRE
- OVERHEAD ELECTRIC POWER
- INFORMATIONAL SIGN (1 OR 2 POST)
- SHORELINE WATER ELEVATION 487.68' (8/15/17)
- ORDINARY HIGH WATER ELEVATION 489.10'

SITE PLAN EXISTING CONDITIONS
SCALE: 1" = 10'
SCALE: 1" = 16'

TEMPORARY BENCH MARK TABLE		
TBM #	ELEV. (FEET)	DESCRIPTION
1	494.36'	SPIKE IN TREE ROOT: 12" DIA. CEDAR

BASED ON ASSUMED DATUM

01/08/2019

STATE OF VERMONT
AGENCY OF NATURAL RESOURCES
DIVISION OF FORESTRY
100 WATERBURY STREET, SUITE 200
WATERBURY, VERMONT 05671-0200

PROJECT: SHADOW LAKE ACCESS AREA
DATE: 01/08/2019
DRAWN BY: [Name]
CHECKED BY: [Name]

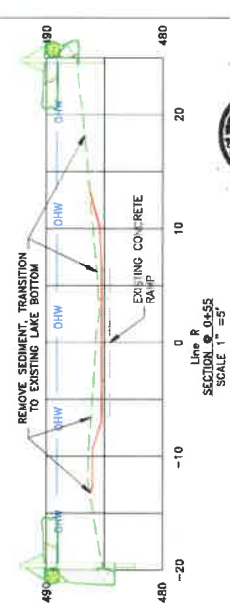
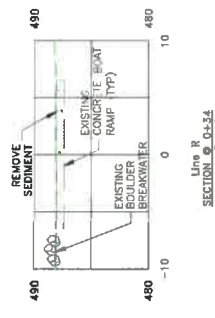
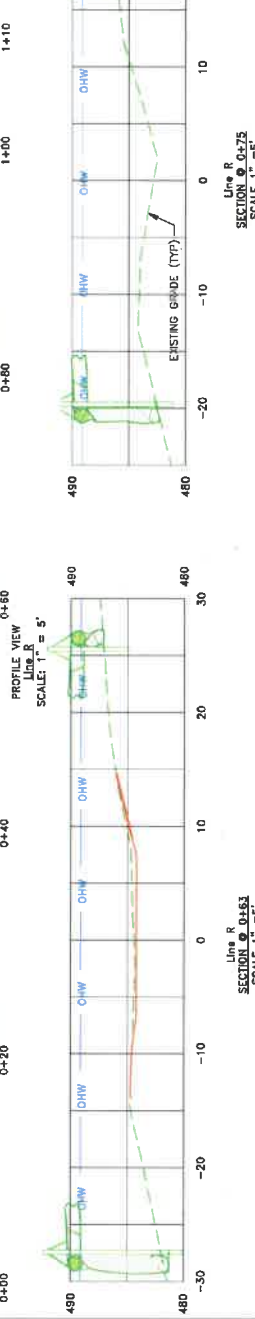
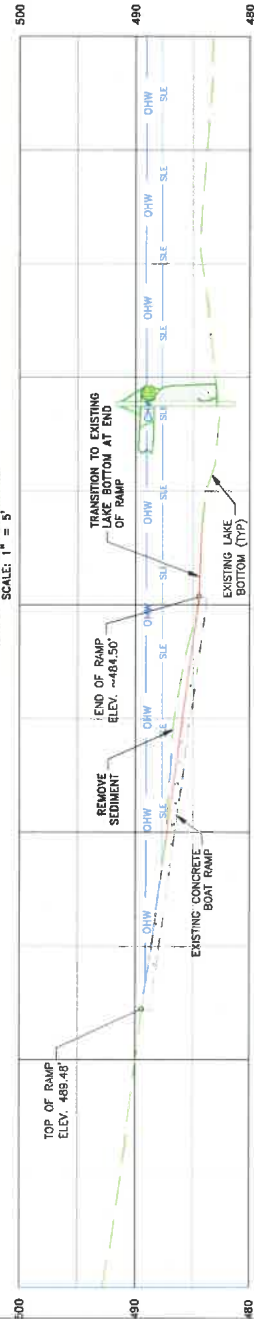
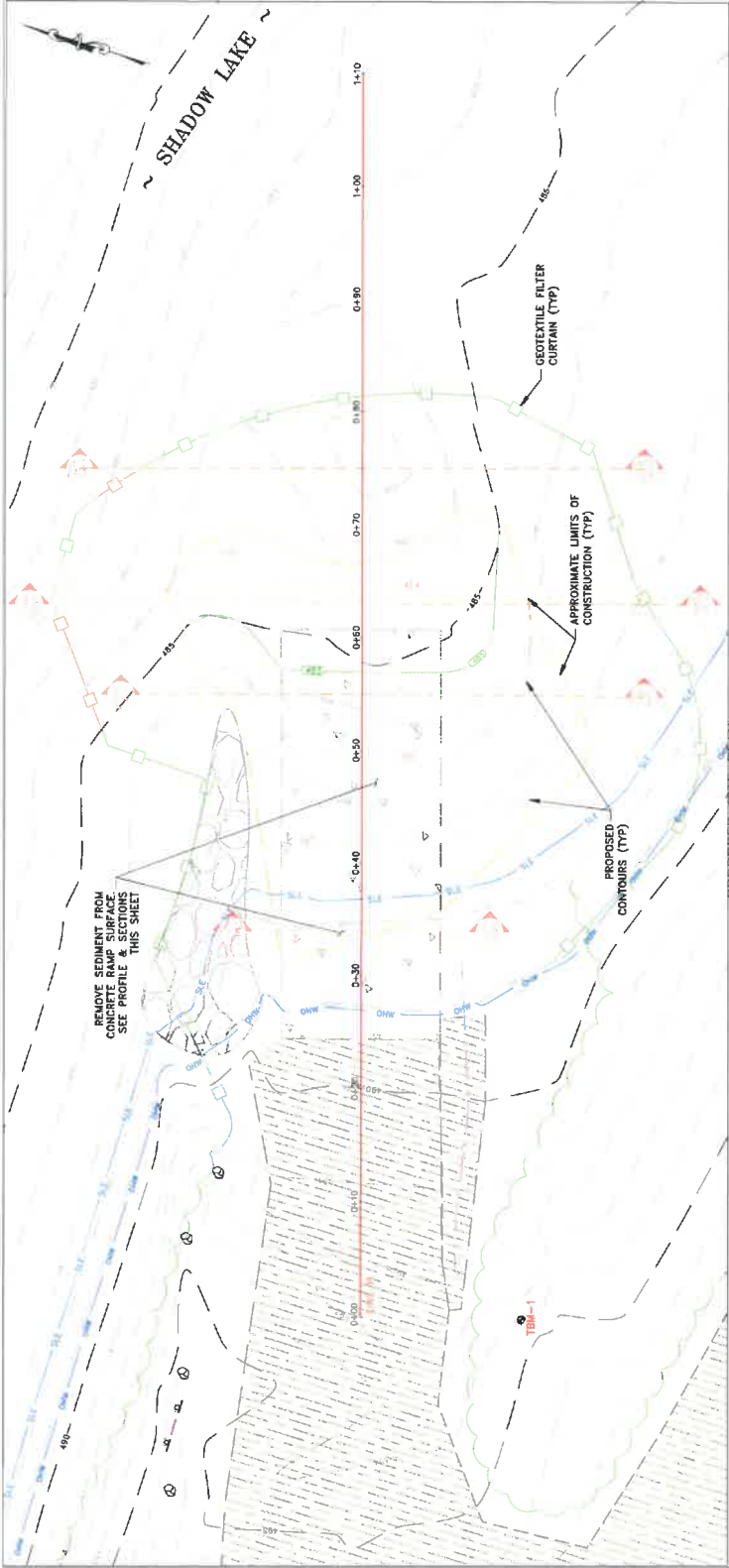

DESIGNED BY	DATE	SCALE
CHECKED BY	DATE	SCALE
APPROVED BY	DATE	SCALE
PROJECT TITLE		
PROJECT LOCATION		
PROJECT DESCRIPTION		
DATE		
DRAWN BY		
SCALE		
SHEET NO.		
TOTAL SHEETS		
PROJECT NO.		
DRAWING NO.		

AGENCY: STATE OF VERMONT, DEPARTMENT OF TRANSPORTATION
PROJECT: SHADOW LAKE ACCESS AREA IMPROVEMENT PROJECT
SECTION: LINE R PROFILE & SECTIONS
DATE: 01/08/2019
DRAWN BY: [Signature]

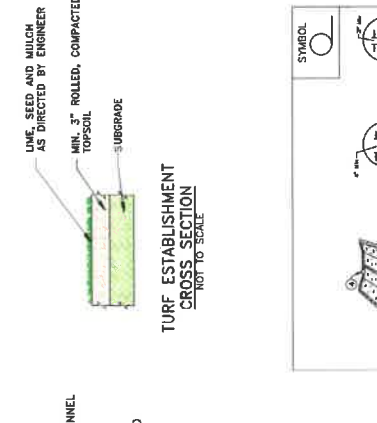

TURF ESTABLISHMENT CROSS SECTION
NOT TO SCALE

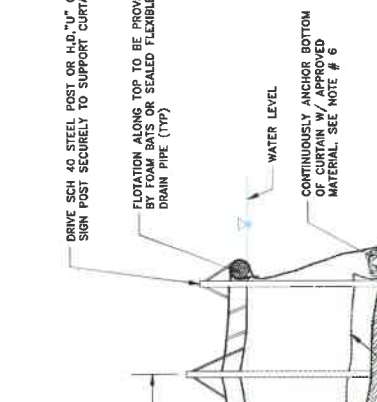

GEOTEXTILE FILTER CURTAIN DETAIL
N.T.S.

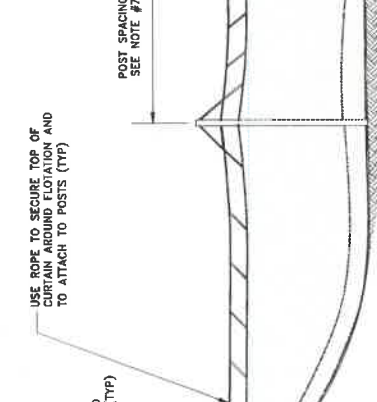

- NOTES:**
1. Filter curtain shall be constructed and completely installed prior to starting any fill or excavation work.
 2. Placement of filter curtain shall allow a minimum of 10 feet between limit of excavation and curtain to prevent disturbance of curtain during work.
 3. Prior to work in the water, the filter curtain shall be inspected and approved by the engineer.
 4. When joining two pieces of filter fabric, overlap shall be at least 6 feet. Method of splicing shall be hand stitching, double row, or approved equal.
 5. Continuous flotation along the top margin shall be provided by closed cell foam bolls or feasible corrugated drain pipe sealed airtight, sized to account for wave and or current forces.
 6. Continuous sealing along the bottom shall be achieved by leaving excess fabric to be anchored with chain, concrete blocks, bricks, steel rod, cable and native material, as shown in the drawing. All non-native materials used for anchoring shall be completely buried.
 7. The spacing of steel posts shall account for vertical and horizontal support to the curtain and the forces of wind, waves and current.
 8. After completion of the work in the water, the filter curtain shall remain in place until turbidity inside the curtain is equal to that outside.
 9. Any turbidity removals the filter curtain to minimize disturbance of the lake or river bottom.

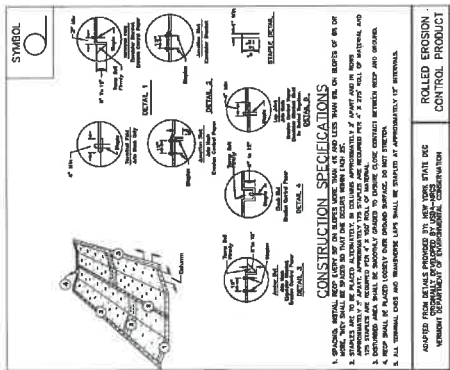

CONSTRUCTION SPECIFICATIONS

A. GRAVEL, SAND, OR OTHER FILL SHALL BE PLACED IN THE TRENCH OR BEHIND THE CURTAIN TO A MINIMUM DEPTH OF 12 INCHES. THE GRAVEL SHALL BE PLACED IN LAYERS NOT THICKER THAN 6 INCHES. THE SAND SHALL BE PLACED IN LAYERS NOT THICKER THAN 4 INCHES. THE FILL SHALL BE PLACED TO A MINIMUM OF 6 INCHES FROM THE CURTAIN TO PREVENT UNDERMINING.

B. ALL TRENCH, CURTAIN AND SANDPAPER LAYS SHALL BE TIGHTLY FIT TOGETHER AT APPROXIMATELY 90 DEGREES.

APPROVED FROM PLANS PROVIDED BY THE USER STATE DEC VERMONT DEPARTMENT OF ENVIRONMENTAL CONSERVATION CONTROL PRODUCT

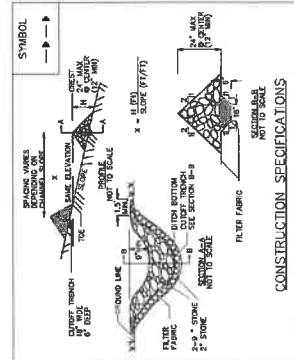

CONSTRUCTION SPECIFICATIONS

1. FILTER FABRIC SHALL BE PLACED OVER THE DRIVE AREA PRIOR TO PLACING OF STONE.
2. FILTER FABRIC SHALL BE PLACED OVER THE DRIVE AREA PRIOR TO PLACING OF STONE.
3. FILTER FABRIC SHALL BE PLACED OVER THE DRIVE AREA PRIOR TO PLACING OF STONE.
4. FILTER FABRIC SHALL BE PLACED OVER THE DRIVE AREA PRIOR TO PLACING OF STONE.
5. FILTER FABRIC SHALL BE PLACED OVER THE DRIVE AREA PRIOR TO PLACING OF STONE.
6. FILTER FABRIC SHALL BE PLACED OVER THE DRIVE AREA PRIOR TO PLACING OF STONE.
7. FILTER FABRIC SHALL BE PLACED OVER THE DRIVE AREA PRIOR TO PLACING OF STONE.
8. FILTER FABRIC SHALL BE PLACED OVER THE DRIVE AREA PRIOR TO PLACING OF STONE.
9. FILTER FABRIC SHALL BE PLACED OVER THE DRIVE AREA PRIOR TO PLACING OF STONE.
10. FILTER FABRIC SHALL BE PLACED OVER THE DRIVE AREA PRIOR TO PLACING OF STONE.
11. FILTER FABRIC SHALL BE PLACED OVER THE DRIVE AREA PRIOR TO PLACING OF STONE.
12. FILTER FABRIC SHALL BE PLACED OVER THE DRIVE AREA PRIOR TO PLACING OF STONE.
13. FILTER FABRIC SHALL BE PLACED OVER THE DRIVE AREA PRIOR TO PLACING OF STONE.
14. FILTER FABRIC SHALL BE PLACED OVER THE DRIVE AREA PRIOR TO PLACING OF STONE.
15. FILTER FABRIC SHALL BE PLACED OVER THE DRIVE AREA PRIOR TO PLACING OF STONE.
16. FILTER FABRIC SHALL BE PLACED OVER THE DRIVE AREA PRIOR TO PLACING OF STONE.
17. FILTER FABRIC SHALL BE PLACED OVER THE DRIVE AREA PRIOR TO PLACING OF STONE.
18. FILTER FABRIC SHALL BE PLACED OVER THE DRIVE AREA PRIOR TO PLACING OF STONE.
19. FILTER FABRIC SHALL BE PLACED OVER THE DRIVE AREA PRIOR TO PLACING OF STONE.
20. FILTER FABRIC SHALL BE PLACED OVER THE DRIVE AREA PRIOR TO PLACING OF STONE.
21. FILTER FABRIC SHALL BE PLACED OVER THE DRIVE AREA PRIOR TO PLACING OF STONE.
22. FILTER FABRIC SHALL BE PLACED OVER THE DRIVE AREA PRIOR TO PLACING OF STONE.
23. FILTER FABRIC SHALL BE PLACED OVER THE DRIVE AREA PRIOR TO PLACING OF STONE.
24. FILTER FABRIC SHALL BE PLACED OVER THE DRIVE AREA PRIOR TO PLACING OF STONE.
25. FILTER FABRIC SHALL BE PLACED OVER THE DRIVE AREA PRIOR TO PLACING OF STONE.
26. FILTER FABRIC SHALL BE PLACED OVER THE DRIVE AREA PRIOR TO PLACING OF STONE.
27. FILTER FABRIC SHALL BE PLACED OVER THE DRIVE AREA PRIOR TO PLACING OF STONE.
28. FILTER FABRIC SHALL BE PLACED OVER THE DRIVE AREA PRIOR TO PLACING OF STONE.
29. FILTER FABRIC SHALL BE PLACED OVER THE DRIVE AREA PRIOR TO PLACING OF STONE.
30. FILTER FABRIC SHALL BE PLACED OVER THE DRIVE AREA PRIOR TO PLACING OF STONE.
31. FILTER FABRIC SHALL BE PLACED OVER THE DRIVE AREA PRIOR TO PLACING OF STONE.
32. FILTER FABRIC SHALL BE PLACED OVER THE DRIVE AREA PRIOR TO PLACING OF STONE.
33. FILTER FABRIC SHALL BE PLACED OVER THE DRIVE AREA PRIOR TO PLACING OF STONE.
34. FILTER FABRIC SHALL BE PLACED OVER THE DRIVE AREA PRIOR TO PLACING OF STONE.
35. FILTER FABRIC SHALL BE PLACED OVER THE DRIVE AREA PRIOR TO PLACING OF STONE.
36. FILTER FABRIC SHALL BE PLACED OVER THE DRIVE AREA PRIOR TO PLACING OF STONE.
37. FILTER FABRIC SHALL BE PLACED OVER THE DRIVE AREA PRIOR TO PLACING OF STONE.
38. FILTER FABRIC SHALL BE PLACED OVER THE DRIVE AREA PRIOR TO PLACING OF STONE.
39. FILTER FABRIC SHALL BE PLACED OVER THE DRIVE AREA PRIOR TO PLACING OF STONE.
40. FILTER FABRIC SHALL BE PLACED OVER THE DRIVE AREA PRIOR TO PLACING OF STONE.
41. FILTER FABRIC SHALL BE PLACED OVER THE DRIVE AREA PRIOR TO PLACING OF STONE.
42. FILTER FABRIC SHALL BE PLACED OVER THE DRIVE AREA PRIOR TO PLACING OF STONE.
43. FILTER FABRIC SHALL BE PLACED OVER THE DRIVE AREA PRIOR TO PLACING OF STONE.
44. FILTER FABRIC SHALL BE PLACED OVER THE DRIVE AREA PRIOR TO PLACING OF STONE.
45. FILTER FABRIC SHALL BE PLACED OVER THE DRIVE AREA PRIOR TO PLACING OF STONE.
46. FILTER FABRIC SHALL BE PLACED OVER THE DRIVE AREA PRIOR TO PLACING OF STONE.
47. FILTER FABRIC SHALL BE PLACED OVER THE DRIVE AREA PRIOR TO PLACING OF STONE.
48. FILTER FABRIC SHALL BE PLACED OVER THE DRIVE AREA PRIOR TO PLACING OF STONE.
49. FILTER FABRIC SHALL BE PLACED OVER THE DRIVE AREA PRIOR TO PLACING OF STONE.
50. FILTER FABRIC SHALL BE PLACED OVER THE DRIVE AREA PRIOR TO PLACING OF STONE.

APPROVED FROM PLANS PROVIDED BY THE USER STATE DEC VERMONT DEPARTMENT OF ENVIRONMENTAL CONSERVATION CHECK DAM

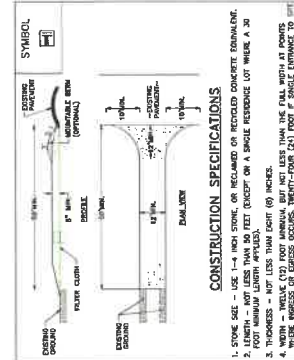

CONSTRUCTION SPECIFICATIONS

1. STONE SIZE - USE 1-4 INCH STONE, OR EQUIVALENT RECYCLED CONCRETE BRICKS/PAVING.
2. STONE SIZE - USE 1-4 INCH STONE, OR EQUIVALENT RECYCLED CONCRETE BRICKS/PAVING.
3. THICKNESS - NOT LESS THAN 8 INCH (6) INCHES.
4. STONE SIZE - USE 1-4 INCH STONE, OR EQUIVALENT RECYCLED CONCRETE BRICKS/PAVING.
5. GEOTEXTILE MUST BE PLACED OVER THE DRIVE AREA PRIOR TO PLACING OF STONE.
6. SURFACE SHALL BE PLACED OVER THE DRIVE AREA PRIOR TO PLACING OF STONE.
7. SURFACE SHALL BE PLACED OVER THE DRIVE AREA PRIOR TO PLACING OF STONE.
8. SURFACE SHALL BE PLACED OVER THE DRIVE AREA PRIOR TO PLACING OF STONE.
9. SURFACE SHALL BE PLACED OVER THE DRIVE AREA PRIOR TO PLACING OF STONE.
10. SURFACE SHALL BE PLACED OVER THE DRIVE AREA PRIOR TO PLACING OF STONE.
11. SURFACE SHALL BE PLACED OVER THE DRIVE AREA PRIOR TO PLACING OF STONE.
12. SURFACE SHALL BE PLACED OVER THE DRIVE AREA PRIOR TO PLACING OF STONE.
13. SURFACE SHALL BE PLACED OVER THE DRIVE AREA PRIOR TO PLACING OF STONE.
14. SURFACE SHALL BE PLACED OVER THE DRIVE AREA PRIOR TO PLACING OF STONE.
15. SURFACE SHALL BE PLACED OVER THE DRIVE AREA PRIOR TO PLACING OF STONE.
16. SURFACE SHALL BE PLACED OVER THE DRIVE AREA PRIOR TO PLACING OF STONE.
17. SURFACE SHALL BE PLACED OVER THE DRIVE AREA PRIOR TO PLACING OF STONE.
18. SURFACE SHALL BE PLACED OVER THE DRIVE AREA PRIOR TO PLACING OF STONE.
19. SURFACE SHALL BE PLACED OVER THE DRIVE AREA PRIOR TO PLACING OF STONE.
20. SURFACE SHALL BE PLACED OVER THE DRIVE AREA PRIOR TO PLACING OF STONE.
21. SURFACE SHALL BE PLACED OVER THE DRIVE AREA PRIOR TO PLACING OF STONE.
22. SURFACE SHALL BE PLACED OVER THE DRIVE AREA PRIOR TO PLACING OF STONE.
23. SURFACE SHALL BE PLACED OVER THE DRIVE AREA PRIOR TO PLACING OF STONE.
24. SURFACE SHALL BE PLACED OVER THE DRIVE AREA PRIOR TO PLACING OF STONE.
25. SURFACE SHALL BE PLACED OVER THE DRIVE AREA PRIOR TO PLACING OF STONE.
26. SURFACE SHALL BE PLACED OVER THE DRIVE AREA PRIOR TO PLACING OF STONE.
27. SURFACE SHALL BE PLACED OVER THE DRIVE AREA PRIOR TO PLACING OF STONE.
28. SURFACE SHALL BE PLACED OVER THE DRIVE AREA PRIOR TO PLACING OF STONE.
29. SURFACE SHALL BE PLACED OVER THE DRIVE AREA PRIOR TO PLACING OF STONE.
30. SURFACE SHALL BE PLACED OVER THE DRIVE AREA PRIOR TO PLACING OF STONE.
31. SURFACE SHALL BE PLACED OVER THE DRIVE AREA PRIOR TO PLACING OF STONE.
32. SURFACE SHALL BE PLACED OVER THE DRIVE AREA PRIOR TO PLACING OF STONE.
33. SURFACE SHALL BE PLACED OVER THE DRIVE AREA PRIOR TO PLACING OF STONE.
34. SURFACE SHALL BE PLACED OVER THE DRIVE AREA PRIOR TO PLACING OF STONE.
35. SURFACE SHALL BE PLACED OVER THE DRIVE AREA PRIOR TO PLACING OF STONE.
36. SURFACE SHALL BE PLACED OVER THE DRIVE AREA PRIOR TO PLACING OF STONE.
37. SURFACE SHALL BE PLACED OVER THE DRIVE AREA PRIOR TO PLACING OF STONE.
38. SURFACE SHALL BE PLACED OVER THE DRIVE AREA PRIOR TO PLACING OF STONE.
39. SURFACE SHALL BE PLACED OVER THE DRIVE AREA PRIOR TO PLACING OF STONE.
40. SURFACE SHALL BE PLACED OVER THE DRIVE AREA PRIOR TO PLACING OF STONE.
41. SURFACE SHALL BE PLACED OVER THE DRIVE AREA PRIOR TO PLACING OF STONE.
42. SURFACE SHALL BE PLACED OVER THE DRIVE AREA PRIOR TO PLACING OF STONE.
43. SURFACE SHALL BE PLACED OVER THE DRIVE AREA PRIOR TO PLACING OF STONE.
44. SURFACE SHALL BE PLACED OVER THE DRIVE AREA PRIOR TO PLACING OF STONE.
45. SURFACE SHALL BE PLACED OVER THE DRIVE AREA PRIOR TO PLACING OF STONE.
46. SURFACE SHALL BE PLACED OVER THE DRIVE AREA PRIOR TO PLACING OF STONE.
47. SURFACE SHALL BE PLACED OVER THE DRIVE AREA PRIOR TO PLACING OF STONE.
48. SURFACE SHALL BE PLACED OVER THE DRIVE AREA PRIOR TO PLACING OF STONE.
49. SURFACE SHALL BE PLACED OVER THE DRIVE AREA PRIOR TO PLACING OF STONE.
50. SURFACE SHALL BE PLACED OVER THE DRIVE AREA PRIOR TO PLACING OF STONE.

APPROVED FROM PLANS PROVIDED BY THE USER STATE DEC VERMONT DEPARTMENT OF ENVIRONMENTAL CONSERVATION STABILIZED ENTRANCE

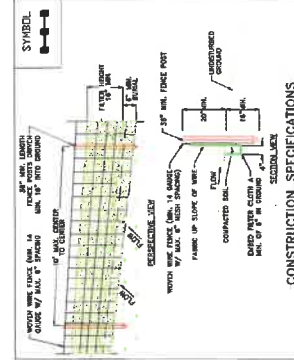

CONSTRUCTION SPECIFICATIONS

1. WOVEN WIRE FENCE TO BE FASTENED SECURELY TO FENCE POSTS WITH WIRE NAILS.
2. FILTER CLOTH TO BE FASTENED SECURELY TO WOVEN WIRE FENCE WITH RES SPACED 12 INCHES ON CENTER.
3. WHEN TWO SECTIONS OF FILTER CLOTH ADJOIN EACH OTHER THEY SHALL BE OVER-LAPPED 12 INCHES.
4. PRE-FABRICATED UNITS SHALL BE COATED, ENVIRO-FLEX, OR APPROVED EQUIVALENT.
5. MAINTENANCE SHALL BE PERFORMED AS NEEDED AND MATERIAL REMOVED WITH SEAMANT RICHES TOOL OF PUBLIC HEARD.

APPROVED FROM PLANS PROVIDED BY THE USER STATE DEC VERMONT DEPARTMENT OF ENVIRONMENTAL CONSERVATION SILT FENCE

SILT FENCE CONSTRUCTION SPECIFICATIONS

THE FOLLOWING IS THE NORMAL SEQUENCE FOR CONSTRUCTION OF

1. DRIVE FENCE POSTS.
2. CONSTRUCT SMALL TRENCH ON THE UP HILL SIDE OF THE FENCE LINE OR ATTACH WIRE FENCE.
3. STAPLE OR ATTACH FILTER FABRIC TO WIRE FENCE ALLOWING SUFFICIENT MATERIAL FOR USE IN THE BOTTOM OF THE TRENCH.
4. BURY THE FILTER FABRIC TO A MINIMUM OF 6 INCHES TO PREVENT UNDERMINING.

IT IS GOOD PRACTICE TO CONSTRUCT THE SILT FENCE ACROSS A FLAT AREA IN THE FORM OF A HORSESHOE. THIS AIDS IN FLOODING THE RUNOFF AND ALLOWING SEDIMENTATION.

NOTE: ALL WORK SHALL BE IN CONFORMANCE WITH THE VT HANDBOOK FOR "THE LOW RISK SITE HANDBOOK FOR EROSION PREVENTION AND SEDIMENT CONTROL". THESE HANDBOOKS ARE AVAILABLE THROUGH THE WATER QUALITY DIVISION, STORMWATER SECTION AT 802-241-3770 OR 241-4320.

ALL WORK SHALL ALSO BE IN CONFORMANCE WITH THE VAOT SPECIFICATION SECTION 105.



PROJECT NO.	DATE	BY	CHKD BY
01/08/2019			
STATE OF VERMONT			
AGRICULTURE, FORESTRY & FISHERIES			
WATER QUALITY DIVISION			
STORMWATER SECTION			
PROJECT NO. 01/08/2019			
DATE 01/08/2019			
BY [Signature]			
CHKD BY [Signature]			

